

PRIMA/S - PRIMA/L



SMALL ARTICULATED FEET
Code PSP



BIG ARTICULATED FEET
Code PS6

ROLLER

BASE FEET 25x90 mm
Code PL329/A

SECOND/THIRD SECTION FEET 25x90 mm
Code PL328/A

BASE MECHANISM
Code FU-085/A

SECOND SECTION MECHANISM
Code FU-085/B

MECHANISM SUPPORT
Code FU-083

WALL WHEEL
Diameter : 100
Code PL-028/A

STRUMENTA/PROFESSIONAL 1



ALUMINIUM DIE CASTING HINGE
Code FU-074



TOOL HOOK
Code PL-047



RUBBER HANDLE
Colour: green
Code PL-046



DOUBLE INCLINED SHOE
Size: 24 x 60. Colour: green
Code PL-012/V

SAFETY STRAP
H 20 mm. L. 570 mm. (P1 6-7). Colour: blue

Code NA-019

SAFETY STRAP
H 20 mm. L. 870 mm. (P1 8-9-10-12).
Colour: blue

Code NA-020

SAFETY STRAP
H 30 mm. L. 540 mm. (P1V 6-7).
Colour: green

Code NA-021

SAFETY STRAP
H 30 mm. L. 840 mm. P1V 8-9-10-12).
Colour: green
Code NA-022



PLUG WITH HOLE FOR STRAP FASTENING
(FIBREGLASS ONLY)
Colour: red
Code PL-321

CONICA



SMALL ARTICULATED FEET 55x120 mm
Code PSP



FIX TIP
Code PU-P65



ARTICULATED TIP
Code PU-P65/S



ARTICULATED RUBBER SHOE 16x11 mm
Code PS-0



HIGH SHOE
Colour: green
Code PL-073

AGRI

BACK TIE-ROD
Length: 600 mm (AG250/AG300)
Code PL-112

BACK TIE-ROD
Length: 840 mm (AG350/AG400)
Code PL-112/1

BACK TIE-ROD
Length: 1195 mm (AG450)
Code PL-112/2

BACK TIE-ROD
Length: 1595 mm (AG500)
Code PL-112/3





BACK TIE-ROD HOOK
Code PL-112/G



**PLUG-IN FEET
(CLIMBING SIDE)**
Size: 30 x 65. Colour: green
Code PL-084



HIGH GREEN SHOE (BACK SIDE POLE)
Code PL-061



STEEL HINGE
Code FE-012



**"U" SHAPED SUPPORT FOR BACK SIDE POLE
FASTENING**
Code PL-113

BACK SIDE POLE WITH BASE SHOE (AG200)

Code AG-RE/20

BACK SIDE POLE WITH BASE SHOE (AG250)

Code AG-RE/25

BACK SIDE POLE WITH BASE SHOE (AG300)

Code AG-RE/30

BACK SIDE POLE WITH BASE SHOE (AG350)

Code AG-RE/35

BACK SIDE POLE WITH BASE SHOE (AG400)

Code AG-RE/40

BACK SIDE POLE WITH BASE SHOE (AG450)

Code AG-RE/45

BACK SIDE POLE WITH BASE SHOE (AG500)

Code AG-RE/50

SUPER PRIMA / VETROPRIMA



BASE ELEMENT ALUMINIUM DIE CASTING HINGE
Size: 25 x 65 right
Code FU-014

BASE ELEMENT ALUMINIUM DIE CASTING HINGE
Size: 25 x 65 left
Code FU-015



BASE ELEMENT ALUMINIUM DIE CASTING HINGE
Size: 25 x 80 right
Code FU-012

BASE ELEMENT ALUMINIUM DIE CASTING HINGE
Size: 25 x 80 left
Code FU-013



BASE ELEMENT ALUMINIUM DIE CASTING HINGE
Size: 25 x 90 right
Code FU-017

BASE ELEMENT ALUMINIUM DIE CASTING HINGE
Size: 25 x 90 left
Code FU-018



PAIR OF SLIDING BRACKETS
Size: 25 x 65. Coated steel

Code PL-023

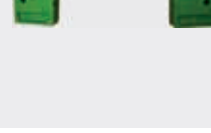

PAIR OF SLIDING BRACKETS
Size: 25 x 80. Coated steel

Code PL-024



PAIR OF SLIDING BRACKETS
Size: 25 x 90. Coated steel
Code PL-025

**RUBBER SHOE
FOR TELESCOPIC BAR**
Code PL-021



**EXPANSION SCREW
FOR SAFETY ANTI-SPLY BAR (Complete)**
Code PL-030



**EXPANSION SCREW FOR STABILISER BAR
"PRIMA"**
Colour: green
Code PL-031



PLUG-IN FEET "PRIMA" 25X65
Colour: green
Code PL-037



PLUG-IN FEET "PRIMA" 25X80
Colour: green
Code PL-039



PLUG-IN FEET "PRIMA"
Size: 25 x 90. Colour: green
Code PL-040



SECOND SECTION ANTI UNTHREADING STOP
Code PL-027



THIRD SECTION ANTI UNTHREADING STOP
Code PL-027/B



ANTI UNTHREADING HOOK FOR RUNG
Only the red nylon part
Code PL-026



RUNG ANTI-UNTHREADING PACK
Metal support+hook+spring
Code GA-ROPM



SAFETY HOOK
Steel
Code FE-038



WALL WHEEL
Size: 100
Code PL-028



SHOE "PRIMA"
Size: 25 x 65. Colour: green
Code PL-042



SHOE "PRIMA"
Size: 25 x 80. Colour: green
Code PL-041



PAIR OF SLIDING BRACKETS "VETROPRIMA"
Size: 25 x 65
Code PL-043

PAIR OF SLIDING BRACKETS "VETROPRIMA"
Size: 25 x 90
Code PL-045



ROPE SLIDING DEVICE
Size: 25 x 80
Code PL-057

ROPE SLIDING DEVICE
Size: 25 x 90
Code PL-058



TELESCOPIC STABILISER BAR "PRIMA"
Codes:
BA-TEL65 (25x65)
BA-TEL80 (25x80)
BA-TEL90 (25x90)



RIGHT SLIDING ELEMENT
Code BA-TEL/SCDX RIGHT

RIGHT SLIDING ELEMENT
Code BA-TEL/SCSX LEFT

PRINTED SLIDING PLATE FOR TELESCOPIC BAR
Code PIASTRINA -01



PRIMA ANTI-SPLAY BARS (SPECIFY MODEL)
Codes:
BA-P1195 (P350-P380-P420-P450)
BA-P840 (P290-P320)
BA-P600 (P210-P240-P260)

DAMA / GENIA



STABILISER BAR "DAMA" - "GENIA"
Size: 77 cm (200 = 2/3 sections)

Code BA-F77

SPECIFY :
DAMA= Green
GENIA= Orange

STABILISER BAR "DAMA" - "GENIA"
Size: 93 cm (260-290 = 2/3/4 sections)

Code BA-F93

STABILISER BAR "DAMA" - "GENIA"
Size: 114 cm (350-380 = 2/3/4 sections)
Code BA-F114



DAMA ANTI-SPLAY BAR
(D260 = 3/4 sections)

Code BA-D750

DAMA ANTI-SPLAY BAR
(D290 = 3/4 sections)

Code BA-D970

DAMA ANTI-SPLAY BAR
(D350/D380 = 2/3/4 sections)
Code BA-D1365



RUBBER SHOE FOR STABILISER BAR "DAMA" - "GENIA"
Code PL-128

SPECIFY:
DAMA= Green
GENIA= Orange



PLUG-IN FEET "GENIA"
Size: 25 x 65. Colour: Orange
Code PL-037/A



PLUG-IN FEET - GENIA
Size: 25 x 90. Colour: Orange
Code PL-040/A



SHOE-GENIA
Size: 25 x 65. Colour: Orange
Code PL-042/A



UPFOR PLUG-IN FEET - GENIA 3 SECTIONS
Size: 25 x 90. Colour: Orange
Code PL-324/A



BASE ALUMINIUM DIE CASTING HINGE "DAMA" - "GENIA"
Size: 25 x 65 right
Code FU-050

BASE ALUMINIUM DIE CASTING HINGE "DAMA" - "GENIA"
Size: 25 x 65 left
Code FU-051



SECOND SECTION ALUMINIUM DIE CASTING HINGE WITH PIVOT AND BRACKET "DAMA" - "GENIA"

Size: 25 x 65 right

Code FU-052

SECOND SECTION ALUMINIUM DIE CASTING HINGE WITH PIVOT AND BRACKET "DAMA" - "GENIA"

Size: 25 x 65 left

Code FU-053



THIRD SECTION ALUMINIUM DIE CASTING HINGE WITH WHEEL SUPPORT "DAMA" - "GENIA"

Size: 25 x 65 right

Code FU-054

THIRD SECTION ALUMINIUM DIE CASTING HINGE WITH WHEEL SUPPORT "DAMA" - "GENIA"

Size: 25 x 65 left

Code FU-055



SECOND SECTION ALUMINIUM DIE CASTING HINGE WITHOUT PIVOT AND BRACKET "DAMA" - "GENIA"

Size: 25 x 65 right

Code FU-056

SECOND SECTION ALUMINIUM DIE CASTING HINGE WITHOUT PIVOT AND BRACKET "DAMA" - "GENIA"

Size: 25 x 65 left

Code FU-057



BASE ALUMINIUM DIE CASTING HINGE "DAMA"

Size: 25 x 90 right

Code FU-060

BASE ALUMINIUM DIE CASTING HINGE "DAMA"

Size: 25 x 90 left

Code FU-061



SECOND SECTION ALUMINIUM DIE CASTING HINGE WITH PIVOT AND BRACKET "DAMA" - "GENIA"

Size: 25 x 90 right

Code FU-062

SECOND SECTION ALUMINIUM DIE CASTING HINGE WITH PIVOT AND BRACKET "DAMA" - "GENIA"

Size: 25 x 90 left

Code FU-063



THIRD SECTION ALUMINIUM DIE CASTING HINGE WITH WHEEL SUPPORT - "DAMA" - "GENIA"

Size: 25 x 90 right

Code FU-064

THIRD SECTION ALUMINIUM DIE CASTING HINGE WITH WHEEL SUPPORT - "DAMA" - "GENIA"

Size: 25 x 90 left

Code FU-065



SECOND SECTION ALUMINIUM DIE CASTING HINGE WITHOUT PIVOT AND BRACKET "DAMA" - "GENIA"

Size: 25 x 90 right

Code FU-066

SECOND SECTION ALUMINIUM DIE CASTING HINGE WITHOUT PIVOT AND BRACKET "DAMA" - "GENIA"

Size: 25 x 90 left

Code FU-067



SAFETY STRAP "DAMA" Green

H: 30 mm. L 2270 mm. (200 = 2 sections)

Colour: green

Code NA-015

SAFETY STRAP "DAMA" Green

H: 30 mm. L 2730 mm. (260 = 2 sections)

Colour: green

Code NA-016

SAFETY STRAP "DAMA" Green

H: 30 mm. L 3060 mm. (290 = 2 sections)

Colour: green

Code NA-017

SAFETY STRAP "GENIA" Orange

H: 30 mm. L 1130 mm. (250 = 2/3 sections)

Colour: Orange

Code NA-032

SAFETY STRAP "GENIA" Orange

H: 30 mm. L 1330 mm. (300 = 2/3 sections)

Colour: Orange

Code NA-033

SAFETY STRAP "GENIA" Orange

H: 30 mm. L 1720 mm. (350 = 2/3 sections)

Colour: Orange

Code NA-035

SAFETY STRAP "GENIA" Orange

H: 30 mm. L 1880 mm. (380 = 2/3 sections)

Colour: Orange

Code NA-036

HOBBY SEI / HOBBY DUE



STABILISER BAR

Size: 77 cm

Code BA-F77

QUADRA / DUPLA



TOOL TRAY Q50

Avail. Colours: black, green, orange (specify)

Code PL-006

TOOL TRAY Q60

Colour: black

Code PL-009



ALUMINIUM DIE CASTING PLATFORM - QUADRA

Code FU-009NT



FRONT SHOE "QUADRA"

Colour: black, green, orange (specify)

Size: 24 x 50 double slope

Code PL-014

FRONT-BACK SHOE "QUADRA"

Size: 24 x 50 mono slope

Code PL-015

FRONT-BACK SHOE - QUADRA

Size: 24 x 60 black

Code PL-012



BRASS/CLUTCH/PIN
 Avail. Colours: black, green, orange (specify)
Code PL-001



"QUADRA" HINGE
 Size: 24 x 50
Code FU-010

"QUADRA" HINGE
 Size: 24 x 60
Code FU-011

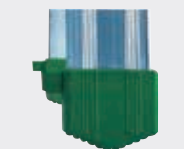

DOUBLE SLOPE SHOE - WITH SPACER
"DUPLA"
 Colour: green
Code PL-051V



STILES SPACER
 Colour: green
Code PL-054V



ALUMINIUM HINGE - LADDER AND STEPSTOOL
"DUPLA"
Code FU-078



ANTI-SPLY BAR - STEP STOOL "DUPLA"
Code FE-098



CAP WITH HOLE - STEP STOOL "DUPLA"
(SAFETY BAR FASTENING)
 Size: 24 x 24
Code PL-130



MONOBLOC
 Two hinges + platforms
Code DU-CEPI



SAFETY STRAP "QUADRA"
 H: 20. L: 755 mm (5/6/7/8 treads). Colour: blue
Code NA-050

SAFETY STRAP "QUADRA"
 H: 20. L: 1090 mm (9/10/11/12/13 gradini).
 Colour: blue
Code NA-051



SAFETY STRAP "DUPLA"
 H: 30. L: 640 mm (5/6 treads). Colour: green
Code NA-008

SAFETY STRAP "DUPLA"
 H: 30. L: 820 mm (7/8/9 treads). Colour: green
Code NA-009

SAFETY STRAP "DUPLA"
 H: 30. L: 1140 mm (10/12 treads). Colour: green
Code NA-010



ALUMINIUM HANDRAIL FOLDING SUPPORT
"QUADRA"
Code FU-109



SAFETY HOOK FOR QUADRA PLATFORM + PIN
 Colour: red
Code PL-315

DIVA



BASE ELEMENT WITH CASTORS "DIVA"
Code DI-TESTATA



LEVELLER "DIVA"
Code AMLV



RAILING "DIVA" (specify the model)
Code DIPAR-90

RAILING "DIVA" (specify the model)
Code DIPAR-120

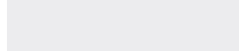

TOE BOARD SUPPORT
Code FU-100

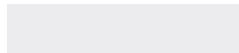

RAILING ADJUSTABLE JOINT
Code FU-101



ANTI-SPLAY BAR "DIVA" 90 FROM 2 TO 3 TREADS
Code BARRA2-3/90

ANTI-SPLAY BAR "DIVA" 90 FROM 4 TO 8 TREADS
Code BARRA4-8/90

ANTI-SPLAY BAR "DIVA" 120 FROM 2 TO 3 TREADS
Code BARRA2-3/120

ANTI-SPLAY BAR "DIVA" 120 FROM 4 TO 8 TREADS
Code BARRA4-8/120

ALFA

HINGE
Code FE-071

HANDLE
Code PL-095A

EUROBRIKO/BRIKO PLUS



PLUG-IN FEET FOR INTERNAL ELEMENTS
Colour: green, orange
Code PL-075



HIGH SHOE FOR EXTERNAL ELEMENTS
Colour: green, Orange
Code PL-073



RUNG LOCKING PIN "EUROBRIKO"
Code PL-072



HINGE LOCKING DEVICE "EUROBRIKO"
Code PL-074



COMPLETE HINGE "EUROBRIKO"
Code SN0DOBK



RUNG COVER "EUROBRIKO" (GREEN)
Code PL-070

RUNG COVER "BRIKO PLUS" (ORANGE)
Code PL-070/A

RUNG CAP "EUROBRIKO" (GREEN)
Code PL-071

RUNG CAP "BRIKO PLUS" (ORANGE)
Code PL-071/A



ALUMINIUM AND STEINLESS STEEL RUNG
LOCKING PIN "EUROBRIKO PLUS"
Code FU-104



AUTOMATIC STEEL HINGE "EUROBRIKO PLUS"
Code FE-069



SAFETY STRAP WITH SNAP-HOOK
"EUROBRIKO"
H: 25. L: 570 mm

Code NA-BK1

SAFETY STRAP WITH SNAP-HOOK
"EUROBRIKO"
H: 25. L: 735 mm

Code NA-BK1,5/2

SAFETY STRAP WITH SNAP-HOOK
"EUROBRIKO"
H: 25. L: 950 mm

Code NA-BK3/4

SAFETY STRAP WITH SNAP-HOOK
"EUROBRIKO"
H: 25. L: 1120 mm

Code NA-BK5

SAFETY STRAP WITH SNAP-HOOK
"EUROBRIKO"
H: 25. L: 1220 mm

Code NA-BK6

CASTIGLIA



TREAD END ELEMENT - WITH SCREWS

Code CA-TGC DX

Code CA-TGC SX

Specify



CS4 ALUMINIUM DIE CASTING SINGLE U BOLT.
UP TO CA6/225
Code FU-023



CS6 ALUMINIUM DIE CASTING DIAGONAL
BRACE SUPPORT FROM CA7/250
Code FU-022



CS5 ALUMINIUM DIE CASTING DOUBLE U BOLT
FOR DOUBLE DIAGONAL BRACE FROM CA7/250
Code FU-024



CS7 ALUMINIUM DIE CASTING PLATE FOR
HANDLE FASTENING
Code FU-025



Ø 80 MM FRONT CASTOR WITH STEEL PIVOT
AND SPRING
Code RU-010/P



Ø125 mm BACK CASTOR - WITH CARPENTRY AND SPRING
Code RU-008



ALUMINIUM DIE CASTING FRONT CASTOR SUPPORT- R (CASTOR-PIVOT AND SPRING NOT INCLUDED)
Code FU-070



ALUMINIUM DIE CASTING FRONT CASTOR SUPPORT- L (CASTOR-PIVOT AND SPRING NOT INCLUDED)
Code FU-071



ALUMINIUM BACK CASTOR SUPPORT - R - FOR Ø 125 MM CASTOR
Code FU-072



ALUMINIUM BACK CASTOR SUPPORT - L - FOR Ø 125 MM CASTOR
Code FU-073



HANDWHEEL FOR TOOL TRAY
Code PL-123



TOOL TRAY
Code CA-POR



RIGHT HANDLE WITH HINGE
Code CA-SNMA

LEFT HANDLE WITH HINGE
Code CA-SNMAS



CASTIGLIA HANDLE HINGE
Code CA-SN



HANDLE WITHOUT HINGE
Code CA-MA



RUBBER HANDLE COVER
Code PL-117



HANDLE CAP
Size: 30 x 50. Colour: green
Code PL-064V

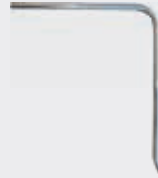

UPFOR LANDING RAIL "CASTIGLIA"
Code CA-MAS



FRONT CASTOR PACK - R
(support + castor + spring)

Code CA-BRAD

FRONT CASTOR PACK - L
(support + castor + spring)
Code CA-BRAS



TREAD PACK

Code CA-BGC

TREAD WITHOUT ALUMINIUM DIE CASTING END ELEMENT
Code CA-E5006

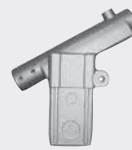

ALUMINIUM FRONT HINGE - L "CASTIGLIA"

Code FU-019

ALUMINIUM FRONT HINGE - R "CASTIGLIA"
Code FU-020



BACK HINGE "CASTIGLIA"

Code FU-021

PLATFORM STEEL HINGE "CASTIGLIA"

Code FE-002

SAFETY SMALL CHAIN WITH CARABINER
Code CA-CT



PLATFORM WITHOUT HINGE "CASTIGLIA"

Code CA-PED

PLATFORM STEEL SUPPORT

Code FE-002

Ø 125 BACK CASTOR

Code RU-017

FORK WITH BRAKE

Code RU-018



DIAGONAL BRACES - I TYPE

The number after the brace identifies the platform size. Handle not included

Code CA-DI / 50-75-100-125-150-175-200

Code CA-DI / 225-250-275-300-325-350

Code CA-DI / 375-400-425-450-500

DIAGONAL BRACES - K TYPE

The number after the brace identifies the platform size

Code CA-DK / 250-275-300-325-350

Code CA-DK / 375-400-425-450-500

PIERCED FRONT STILE

R/L - without ironware

Code CA-MONT / 50-75-100-125-150-175-200-225-250

Code CA-MONT / 275-300-325-350-375-400-425-450-500

WELDED BACK STRUCTURE

Without ironware

Code CA-RE / 50-75-100-125-150-175-200-225-250

Code CA-RE / 275-300-325-350-375-400-425-450-500



TOE BOARD AND PLATFORM CAP

Size: 18 x 150. Colour: green

Code PL-116

CASTÀ / PLATEA



TOOL TRAY - ORANGE

Code PL-017



ALUMINIUM DIE CASTING PLATFORM

Code FU-038



FOLDING HANDRAIL

Code CTA-MANIG



ALUMINIUM FOLDING HANDRAIL SUPPORT

Code CTA-SMANIG/DX right



ALUMINIUM FOLDING HANDRAIL SUPPORT

Code CTA-SMANIG/SX left



ADJUSTABLE STABILISER FOR CTA-4

Code CTA-STAB4

(Specify if left or right)

ADJUSTABLE STABILISER FOR CTA-5

Code CTA-STAB5

(Specify if left or right)

ADJUSTABLE STABILISER FOR CTA-6

Code CTA-STAB6

(Specify if left or right)

ADJUSTABLE STABILISER FOR CTA-7

Code CTA-STAB7

(Specify if left or right)

ADJUSTABLE STABILISER FOR CTA-8

Code CTA-STAB8

(Specify if left or right)



ADJUSTABLE STABILISER FOR CTA-9

Code CTA-STAB9

(Specify if left or right)

ADJUSTABLE STABILISER FOR CTA-10

Code CTA-STAB10

(Specify if left or right)

ADJUSTABLE STABILISER FOR CTA-11

Code CTA-STAB11

(Specify if left or right)



ANTI SPLAY BAR

LENGTH 860 mm CTA 4/5

Code CTA-COMP860

LENGTH 1050 mm CTA 6/7

Code CTA-COMP1050

LENGTH 1240 mm CTA 8/9

Code CTA-COMP1240

LENGTH 1450 mm CTA 10/11

Code CTA-COMP1450



STABILISER BAR WITH 2 CASTOR SUPPORT HINGES+2 CASTOR COVERS

(CASTOR SUPPORTS AND CASTORS NOT INCLUDED)

LENGTH 810 mm CTA 3/4/5/6

Code CTA-BARRA810

LENGTH 1055 mm CTA 7/8

Code CTA-BARRA1055

LENGTH 1265 mm CTA 9/10

Code CTA-BARRA1265

LENGTH 1385 mm CTA 11

Code CTA-BARRA1385

HANDRAIL 670 FOR CTA-4

WITHOUT SUPPORTS

Code CTA-MAN670

HANDRAIL 900 FOR CTA-5

WITHOUT SUPPORTS

Code CTA-MAN900

HANDRAIL 1150 FOR CTA-6

WITHOUT SUPPORTS

Code CTA-MAN1150

HANDRAIL 1410 FOR CTA-7

WITHOUT SUPPORTS

Code CTA-MAN1410

HANDRAIL 1680 FOR CTA-8

WITHOUT SUPPORTS

Code CTA-MAN1680

HANDRAIL 1920 FOR CTA-9

WITHOUT SUPPORTS

Code CTA-MAN1920

HANDRAIL 2150 FOR CTA-10

WITHOUT SUPPORTS

Code CTA-MAN2150

HANDRAIL 2400 FOR CTA-11

WITHOUT SUPPORTS

Code CTA-MAN2400



STEEL FRONT GUARDRAIL
Code CTA-PAR

ANTI SPLAY STRAP - CTA-3
Code NA-044

1-BACK CASTOR SUPPORT ALUMINIUM DIE CASTING HINGE

RIGHT: Code FU-203DX
LEFT: Code FU-203SX

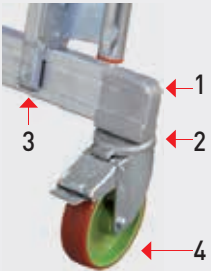

1-ALLUMINIUM DIE CASTING CASTOR COVER PLATE
Code FU-205

3-ALUMINIUM DIE CASTING STABILISER BAR SUPPORT FORK
Code FU-114/A

4-Ø 125 MM BACK CASTOR WITH BRAKE
Code RU-008

1-Ø 80 MM FRONT CASTOR WITH STEEL PIVOT AND SPRING
Code RU-010/P



2-ALUMINIUM DIE CASTING FRONT CASTOR SUPPORT
Code FU-207



1-BACK SIDE WITH HINGES AND FORKS

- CTA-3: Code CTA-RE/3
- CTA-4: Code CTA-RE/4
- CTA-5: Code CTA-RE/5
- CTA-6: Code CTA-RE/6
- CTA-7: Code CTA-RE/7
- CTA-8: Code CTA-RE/8
- CTA-9: Code CTA-RE/9
- CTA-10: Code CTA-RE/10
- CTA-11: Code CTA-RE/11

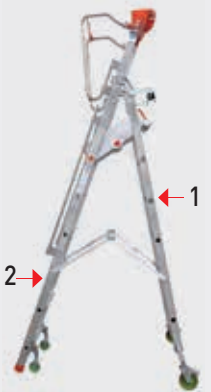

2-CLIMBING SIDE WITHOUT TOOL TRAY/ PLATFORM/CASTOR SUPPORTS

- CTA-3: Code CTA-ANT/3
- CTA-4: Code CTA-ANT/4
- CTA-5: Code CTA-ANT/5
- CTA-6: Code CTA-ANT/6
- CTA-7: Code CTA-ANT/7
- CTA-8: Code CTA-ANT/8
- CTA-9: Code CTA-ANT/9
- CTA-10: Code CTA-ANT/10
- CTA-11: Code CTA-ANT/11

S/15



PAIR OF VERTICAL TOP HANDRAILS - S/15 WITH CLUTCHES
Code S15-MCVER



PAIR OF STANDARD TOP HANDRAILS - S/15 WITH VERTICAL CLUTCHES
Code S15-MCSTD



HANDRAIL STRAIGHT CLUTCH - S/15
Code FE-028

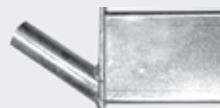

HANDRAIL VERTICAL CLUTCH - S/15
Code FE-028/B

WELDED STRENGTHENING - S/15 - FOR MAXI SIZES
Code S15/ES-013

BINARY

1- ALUMINIUM DIE CASTING CARRIAGE WITH HANDWHEELS AND BEARINGS
Cod. FU-124

HANDWHEEL WITH CARRIAGE CLUTCH
Cod. PL-333

2- BIG TWO-LANES ALUMINIUM DIE CASTING JOINT
Cod. FU-122

3- DIAGONAL BRACE (SPECIFY THE MODEL)
Cod. BY-DIAG

4- PLATFORM WITHOUT STEEL SUPPORT
Cod. CA-PED

PLATFORM STEEL SUPPORT
Cod. FE-002

5- HORIZONTAL BRACE WITH STEEL JOINT
Cod. BY-TRAV

6- SMALL ALUMINIUM DIE CASTING JOINT
Cod. FU-123

8- GUARDRAIL
Cod. CA-MAS

9- RAILING (SPECIFY THE MODEL)
Cod. MAN

FIX HANDRAIL SUPPORT
Cod. FU-016

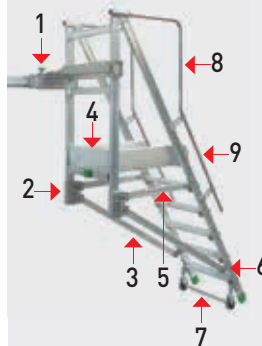



WALL SPACER WITH WHEEL
Code FE-182



ALUMINIUM FRONT HINGE - LEFT
Code FU-019
ALUMINIUM FRONT HINGE - RIGHT
Code FU-020



ALUMINIUM BACK HINGE
Code FU-021
PLATFORM STEEL HINGE
Code FE-002
SAFETY SMALL CHAIN WITH CARABINER
Code CA-CT



1-Ø 80 MM FRONT CASTOR WITH STEEL PIVOT AND SPRING
Code RU-010/P

7- CASTOR JUNCTION TUBE
Code BY-COLL



2-ALUMINIUM DIE CASTING FRONT CASTOR SUPPORT
Code FU-207

SPAZIO



ZINC-PLATED HANDWHEEL FOR BASE ELEMENT "SPAZIO"
Code SPA-VOL



LEVELLERS HANDWHEEL
Colour: green
Code PL-031



BASE PACK CASTOR WITH BRAKE "SPAZIO"
Size: 200
Code RU-004



PLATFORM CLUTCHES "SPAZIO"
Code FE-016

BASE PACK HORIZONTAL BRACE
Code STRB

BASE ELEMENT WITH TWO CASTORS WITH BRAKE
Code STB

ADJUSTABLE LEVELLER
Code SL

125 CM LADDER FRAME (5 RUNGS)
Code SS1

65 CM LADDER FRAME (FOR END EXT. PACK - 3 RUNGS)
Code SS2

SIDE HORIZONTAL BRACE
Code ST

EXTENSION PACK DIAGONAL BRACE
Code SSA1

END EXTENSION PACK RED DIAGONAL BRACE
Code SSA2

RED END HANDRAILS
Code SMT

RED SIDE RUNG FOR END EXTENSION PACK
Code STT

BASE PACK DIAGONAL BRACE
Code SSB

RED VERTICAL TIE-ROD FOR EXTENSION PACK
Code STA

RED VERTICAL TIE-ROD FOR END EXTENSION PACK
Code STI

PONY

PAIR OF WOODEN PLATFORMS
Code LE-002
Pair of diagonal braces
HANDRAIL
LADDER FRAME WITHOUT CASTORS
LADDER FRAME WITH CASTORS

MITO

100 CM SIDE LADDER FRAME
Code S100/M

200 CM SIDE LADDER FRAME
Code S200/M

BASE ELEMENT WITH CASTORS
Code BCR/M

HORIZONTAL BRACE WITH 4 DIAGONAL BRACES
Code TRV/M

STABILISER
Code STB/M

LEVELLER
Code AMLV



BASE PACK CASTOR WITH BRAKE - "MITO"
Size: 125
Code RU-013

END HANDRAIL WITH DIAGONAL BRACES
Code MT/M

SAFETY GUARDRAIL
Code RP/M

TWO PAINTED WOODEN PLATFORMS PACKS
Code PLSL/M

ADJUSTABLE STAIRWELL DEVICE
Code ELZ/M

RED DIAGONAL BRACE
Code MI SAETTA



LEVELLERS HANDWHEEL
Colour: green
Code PL-031

SAFETY GUARDRAIL HANDWHEEL
Code PL-120

ALUMITO / ALUMAXI



BASE ELEMENT WITH CASTORS
Code AMTB



LEVELLER
Code AMLV

SIDE HORIZONTAL BRACE
Code AMTL

4 RUNGS LADDER FRAME
H 1200 mm
Code AMSP-4

6 RUNGS LADDER FRAME
H 1800 mm
Code AMSP-6

DIAGONAL BRACE - 1750 MM
For extension pack - 1200 mm
Code AMS-17

DIAGONAL BRACE - 2100 MM
For extension pack - 1800 mm
Code AMS-21

END HANDRAIL
Code AM-MA



CASTOR WITH BRAKE
Size: 125
Code RU-013



HORIZONTAL BRACE ALUMINIUM DIE CASTING
CROSS VAULT JOINT
Including pin
Code D674-C



CROSS VAULT SPRING PIN
Colour: green
Code PL-064



PLASTIC PIECE FOR DIAGONAL BRACE
FASTENING
Code PL-306L



STABILISER CLAMP - WITH HANDWHEELS
Code D672



CLAMP HANDWHEEL
Code PL-312



LEVELLER HANDWHEEL
Code PL-031

PINNA/PINNA CLIC/ PINNA CLIC•CLAC

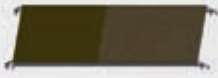

WORKING PLATFORM
Code PIAN-PN



DIAGONAL BRACE WITH 2 LEVERS
Code PN-SAET1555

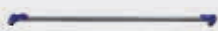

HORIZONTAL BRACE WITH 2 LEVERS
Code PN-SAET1440



1-STABILISER BAR WITH 2 RUBBER SHOES
Code BA-PN1207



2-LADDER FRAME WITH EXTENSION + 2 HINGES
Code PN-FIAN

Specify if with or without castors holes



ALUMINIUM DIE CASTING HINGE
Code SNODOPN

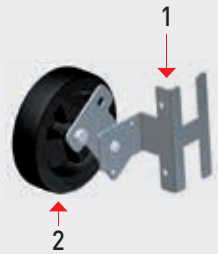

1-STEEL LIFTING CASTOR SUPPORT

RIGHT: Code FE-177/DX
LEFT: Code FE-177/SX

Ø 125 MM BLACK RUBBER CASTOR
Code RU-035



STABILISER BAR NYLON FORK
Code PL-133/Blue



STEEL SAFETY PIN (CLIC/CLIC•CLAC)
Code PL-344



STEEL COATED JOINT (CLIC/CLIC•CLAC)
Code PL-143



1- 5-6 RUNGS BASE LADDER FRAME
(CLIC / CLIC•CLAC)

Code PN-CLI/SPB

2- 6 RUNG EXTENSION PACK LADDER FRAME
(CLIC / CLIC•CLAC)

Code PN-CLI/SPA

3- 7 RUNGS EXTENSION PACK LADDER FRAME
(CLIC•CLAC)

Code PN-CLI/PRO



7 RUNGS EXTENSION PACK LADDER FRAME
(CLIC / CLIC•CLAC)

Code FE-188



ADJUSTABLE STABILISER (CLIC•CLAC)

Code PN-STAB

PENNY

LADDER FRAME
Code PE-SPA

TOOL TRAY
Code PL-350

Ø -90 MM CASTOR
Code RU-036

WORKING PLATFORM WITH 2 DIAGONAL BRACES
Code PE-PIAN

DIAGONAL BRACE
Code PE-DIAG

STABILISER BAR
Code PE-BARRA

CASTOR SUPPORT WITH CASTOR
Code FE-192

NYLON HOOK FOR PLATFORM FASTENING
WITHOUT SAFETY STOP
Code PL-346

STEEL SAFETY STOP FOR NYLON HOOK
Code FE-220

TANO

4 RUNGS LADDER FRAME WITH CASTORS
Code TA-SPCR

5 RUNGS LADDER FRAME WITHOUT CASTORS
Code TA-SPSR

HORIZONTAL BRACE 1400 MM
Code TA-TR0

DIAGONAL BRACE 1650 MM
Code TA-TRD

NYLON HANDWHEEL
Code PL-031

GREEN STABILISER
Code TA-STBV

WOODEN TOOL TRAY SHELF
Code TA-ME

WOODEN PLATFORM
Code LE-012

HANDWHEEL NOG
Code PL-309

PLUG-IN FEET WITH HOLE 25X65 MM
Code PL-303

PLUG-IN FEET 25X65 MM
Code PL-037

ESTRO

LADDER FRAME WITH CASTORS
Code ES-SP

END HANDRAIL
Code PI-MA

BASE ELEMENT HORIZONTAL BRACE
Code ES-TR

DIAGONAL BRACE
Code ES-SA

CASTOR WITH BRAKE
Code RU-027

CASTOR WITHOUT BRAKE
Code RU-029

PLATFORM
Code ES-TA

TWO STABILISER WITH CLAMPS
Code AMZP

PLASTIC PIECE FOR DIAGONAL BRACE
FASTENING
Code PL-306

PIEGO

STRUCTURE WITH CASTORS
Code PI-ST

2 PLATFORMS PACK
Code LE-001

DIAGONAL BRACE
Code PI-SA

END HANDRAIL
Code PI-MA

Ø 125 MM CASTOR WITH BRAKE
Code RU-013

ACCESSORIES BAG
Code SA-001

DOGE/65

Ø 150 MM CASTOR WITH BRAKE
Code RU-025

CASTOR SUPPORT BLOCK
Code FU-026

COATED STEEL JOINT
Code PL-300

HORIZONTAL BRACE DIE CASTING CROSS
VAULT JOINT INCLUDING PINS
Code D674-C

CROSS VAULT SPRING PIN
Code PL-064

LADDER FRAME PLASTIC PIECE
Code PL-306/L

DIAGONAL BRACE STAINLESS STEEL SPRING
Code PL-307

SIMPLE SAFETY RAILING
Code D679-S

SAFETY RAILING WITH ADDITIONAL STOREY
Code D679-P

STABILISER CLAMP WITH HANDWHEEL
Code D672

CLAMP HANDWHEEL
Code PL-312

LEVELLER HANDWHEEL
Code PL-031

SAFETY HOOK
Code FU-032

WORKING PLATFORM SUPPORT HOOK
Code D6/ES-109

STABILISER GREEN SHOE Ø 50 MM
Code PL-301

STABILISER GREEN PLUG-IN CAP Ø 520 MM
Code PL-219

DOGE/80

Ø 200 MM CASTOR WITH BRAKE
Code RU-034

CASTOR SUPPORT BLOCK
Code FU-045

COATED STEEL JOINT
Code PL-320

HORIZONTAL BRACE DIE CASTING CROSS
VAULT JOINT INCLUDING PINS
Code D823

CROSS VAULT SPRING PIN
Code PL-064

LADDER FRAME PLASTIC PIECE
Code PL-299

DIAGONAL BRACE STAINLESS STEEL SPRING
Code PL-307

SIMPLE SAFETY RAILING
Code D826

SAFETY RAILING WITH ADDITIONAL STOREY
Code D827

STABILISER CLAMP WITH HANDWHEEL
Code D828

CLAMP HANDWHEEL
Code PL-312

LEVELLER HANDWHEEL
Code PL-031

SAFETY HOOK
Code FU-032

WORKING PLATFORM SUPPORT HOOK
Code D6/ES-112

STABILISER GREEN SHOE Ø 50 MM
Code PL-301

STABILISER GREEN PLUG-IN CAP Ø 520 MM
Code PL-219

EURODOMUS

ORANGE PLATFORM
Code FE-194/A

BLACK PLATFORM
Code FE-194/N

FRONT SHOE - ORANGE 40X20 MM
Code PL-356/A

FRONT SHOE - BLACK 40X20 mm
Code PL-356/N

BACK SHOE - ORANGE 40X20 mm
Code PL-357/A

BACK SHOE - BLACK 40X20 mm
Code PL-357/N

ORANGE TOOL TRAY - PLUS
Code PL-358/A

BLACK TOOL TRAY - PLUS
Code PL-358/N

LEFT TREAD CAP - ORANGE
Code PL-359/A-SX

RIGHT TREAD CAP - ORANGE
Code PL-359/A-DX

LEFT TREAD CAP - BLACK
Code PL-359/N-SX

RIGHT TREAD CAP - BLACK
Code PL-359/N-DX

ORANGE SAFETY STRAP
680 mm 5/6/7 treads
Code NA-055/A

ORANGE SAFETY STRAP
1090 mm - 8 treads
Code NA-056/A

BLACK SAFETY STRAP
680 mm - 5/6/7 treads
Code NA-055/N

BLACK SAFETY STRAP
1090 mm - 5/6/7 treads
Code NA-056/N

COLORETTE

FRONT SHOE 35X20 mm BLACK
Code PL-360/N

FRONT SHOE 35X20 mm ORANGE
Code PL-360/A

FRONT-BACK SHOE 30X20 mm BLACK
Code PL-361/N

FRONT-BACK SHOE 30X20 mm ORANGE
Code PL-361/A

BLACK SAFETY STRAP
620 mm - 5/6/7/8 treads
Code NA-057/N

ORANGE SAFETY STRAP
620 mm - 5/6/7/8 treads
Code NA-057/A

TINTO / TONTO

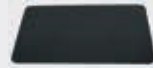

BLACK PLASTIC PLATFORM TONTO
Code PL-371



GREY TREAD WITH BLACK PLASTIC
Code FE-217



WHITE TREAD WITH BLACK PLASTIC
Code FE-218



BLACK ANGULAR BACK SHOE
Code PL-370



BLACK FRONT SHOE TONTO
Code PL-369



ZINC-PLATED HINGE TONTO
Code PL-368



ORANGE HINGE TONTO
Code FE-219



ORANGE HINGE - TINTO
Code PL-367



SHINY BLACK TREAD - TINTO
Code FE-216



DIAGONAL BRACES (TINTO 3)
Code FE-215



ORANGE TREAD SPACER - TINTO
Code PL-366



ORANGE FRONT SHOE - TINTO 20X30 mm
Code PL-365



ORANGE ANGULAR BACK SHOE TINTO
Code PL-364



ORANGE BACK SHOE - TINTO 4
Code 372

OTHER GENERIC SPARE PARTS



UNIVERSAL STANDOFF
Code APP



UNEVEN GROUND PINS
Size: 25x65 (pair)
Code PU-P65



UNEVEN GROUND PINS
Size: 25 x 80 (pair)
Code PU-P80



CLAMP WITH CHAINSAW COVER FOR SAWHORSE
Code CAV-M



ALUMINIUM SAWHORSE HINGE
Code FU-200

ALUMINIUM SAWHORSE SAFETY BAR
Code FE-054

BLOCK WITH HOLE FOR SAFETY BAR FASTENING (CAV/A)
Colour: green
Code PL-317



CHAINSAW COVER FOR SAWHORSE (CAV/C)
Code FE-033

SHOE Ø 30 mm (PLANO/PLANO MAXI/RIGOLO)
Code PL-327

INACTIVE CASTOR Ø 90 mm RIGOLO PLUS AND PALCO
Code RU-036

INACTIVE CASTOR Ø 90 mm WITH SUPPORT RIGOLO PLUS AND PALCO
Code FE-192/1

PLATFORM GREEN CAP - 20X80 mm FOR ALUMINIUM SAWHORSE
Code PL-104